

# Swivel castor with total lock CSST 125 TLSK

Transport Series CD - Wheel TLS

-20 °C - +80 °C

+++  
swivels easily

+++  
wear resistant

++  
shock proof

+++  
floor protective

++  
weather proof

## Wheel



Tread: cast polyurethane, 70±3 Shore A

Core: Die-cast aluminium alloy

## Fork



Finish: electro-zinc plated, double ball bearing – revited, hardened steel balls thermoplastic dust protection ring, wheel axle bolted, total lock

Swivel castor with total lock Wheel-Ø A x width B mm: 125x50

Load Capacity kg: 200

Load capacity tested according to EN 12530 and EN 12527

Overall height H mm: 160

Dimension of top plate TP 135x110 mm:

Hole spacing HS mm: 105x80

Hole-Ø HD mm: 12.5

Swivel radius SR mm: 140

Wheel bearing: Ball bearing

## Advantages

- ✓ very silent in motion
- ✓ low rolling resistance
- ✓ high abrasion and tear resistance
- ✓ high resistance to shocks
- ✓ easy to clean
- ✓ good chemical resistance

©Copyright 2024 Rollenbau GmbH, www.rollenbau.at 20.05.2024

ROLLENBAU

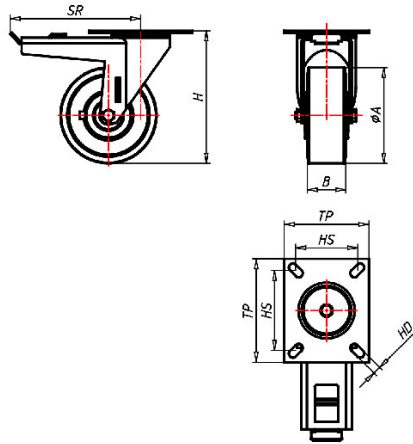

## Applications

- Metal-Technology
- Workshops
- Dollies
- Carpentry
- Building-Industry